

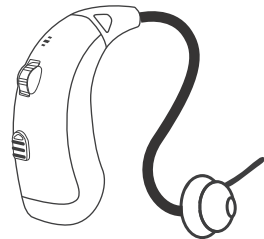

VER: D58-20210923-V01

HEARING AMPLIFIER

Instruction Manual Model: JH-D58



Please read this user manual thoroughly and completely before using the product.

CONTENTS

I.IMPORTANT SAFETY INSTRUCTIONS	
1.CONTRAINDICATION	
2.WARNINGS	
3.NOTICE	03

II.DO NOT USE IF ANY OF THE FOLLOWING APPLY	06

TO YOU	

III.MATTERS NEEDING ATTENTION, WARNINGS	07

AND TIPS	

IV.HOW TO USE YOUR DEVICE	08

1.HOW TO APPLY DOMES	08

2.LEFT & RIGHT HEARING AMPLIFIER MARKINGS	10

3.VOLUME ADJUSTMENT	11

4.HEARING MODE CHANGE	12

5.REPLACING TUBING	13

6.HOW TO USE THE CHARGING CASE	14

V. MAINTENANCE AND CLEANING	17

VI. HEARING AMPLIFIERS CARE	18

VII.TROUBLESHOOTING GUIDE	20

VIII.TIPS FOR BETTER COMMUNICATION	24

IX.TECHNICAL SPECIFICATION	26

X. ACCESSORIES LIST	26

XI.NORMALIZED SYMBOLS	27

XII.MAINTENANCE, STORAGE, AND DISPOSAL	28

XIII.WARRANTY	29

I. IMPORTANT SAFETY INSTRUCTIONS

Read all the information in this instruction manual and any other literature included in the box before using the device.

1. CONTRAINDICATION

The device should not be used in the following situations:

- Patients with chronic suppurative otitis media (CSOM), congenital ear atresia, or any type of ear discharge
- Anyone under 36 months old

2. WARNINGS ⚠

- Keep small parts (hearing instrument, ear domes, battery or other detachable parts) that can be swallowed out of children's reach. Dropping, immersing in liquid, exposure to strong electromagnetic fields or excessive heat will damage the hearing amplifiers. Remove devices prior to any type of X-ray, MRI, or CT scan. If parts become stuck in the ear canal, seek medical assistance - do not attempt to remove by yourself.

3. Notice ⚠ Warning

- Do not use at high volume for extended periods of time - ear injury can result.
- If you experience any pain or strong discomfort using the devices, remove and consult a doctor.

- Routine maintenance to keep the device clean is required. Ensure that ear domes are free of debris and moisture at all times.

- Avoid shocks or dropping the product.

- Do not store or use the product in environments of high humidity or temperature (such as sauna room), to avoid damage.

- Batteries should be properly recycled and not disposed in the trash.

- Keep the devices away from small children. Injury or damage may result.

- Do not set volume levels too high. Listening with high-output devices for extended periods at high volume levels can cause further hearing damage.

- Do not share your hearing amplifiers with others. Using a hearing amplifier configured for someone else can result in hearing damage or injury.

- Monitor for any unusual skin reaction. If you notice any allergic reaction (itchiness, swelling, or rash), stop wearing the hearing amplifiers and consult a medical specialist.

- Do not touch the hearing amplifiers to any type magnet or magnetized object. Your hearing amplifiers are delicate electronic instruments and may be damaged by contact with

strong magnetic fields.

- Do not attempt to open or repair the devices yourself. Damage can result and will void the warranty.

- Do not store your devices in a hot/humid locations. You should never leave your hearing amplifiers near heating appliances or in direct sunlight.

- Do not leave your hearing amplifiers in the car as inside temperatures can reach dangerous levels which could damage the devices.

- Do not use the hearing amplifiers together with a cell phone earpiece directly - excessive noise and distortion may result. Instead, use via Bluetooth pairing with your cell phone. Radio wave emissions from mobile phones can cause noise in the hearing amplifiers or result in reduced volume.

- Please contact the MANUFACTURER:

- For assistance, if needed, in setting up, using or maintaining your devices or to report any unexpected operation or events

Specific warnings / statements
Keep small parts away from and out of children's reach to avoid accidental ingestion
Warning not to use in explosive or oxygen-enriched atmospheres, as doing so may damage the device
Warning that it should only be used by intended person as using hearing amplifiers designed for someone else may result in hearing damage

II. DO NOT USE IF ANY OF THE FOLLOWING APPLY TO YOU:

- 1) Congenital atresia of external ear or deformity of any part of the ear canal
- 2) Deafness is unstable, and the degree of hearing loss often fluctuates
- 3) Persistent headaches, dizziness, earaches, tinnitus or other symptoms that are not suitable for adaptation
- 4) Sudden onset of hearing loss within the past 3 months; rapid progressive deafness; unilateral hearing loss or other acute ear disease;
- 5) Effusion (secretions/discharge) in the ear and/or frequent purulence (pus)

- 6) Central deafness (central nervous system) or non-organic deafness
- 7) Patients with acute otitis externa and tympanitis
- 8) Patients with acute and chronic suppurative otitis media (in the period of purulent infection)
- 9) Patients who are allergic to the materials of this product

III. Matters needing attention, warnings and tips

1. Do not immerse the hearing amplifier in any liquid. Remove the hearing amplifier before swimming or bathing. After swimming or washing, wait for the ear canal to dry before wearing the hearing amplifier.
2. After removing the hearing amplifier at night, it should be placed in a case with a desiccant if possible, protected from light, high temperature and high humidity environment.
3. The external surfaces of the hearing amplifier should be kept clean, and earwax in the ear domes should be cleaned out daily
4. Applicable objects: Suitable for people with air-conducting hearing loss of about 30-50dB
5. When you do not use hearing amplifiers, please charge the product regularly to avoid battery damage; the recommended charging time interval of hearing amplifiers is ≤ 28 days

IV. HOW TO USE YOUR DEVICE

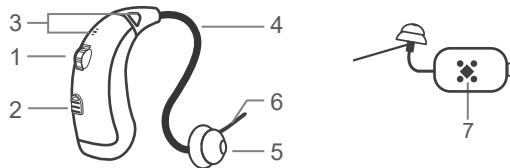

1. Volume Control / Turn ON/ Turn OFF
2. Hearing Mode Change
3. Microphones
4. Ear Tube
5. Ear Dome
6. Stabilization Bar
7. Charging contacts

【HOW TO APPLY DOMES】

Step 1: Choose a suitable size ear dome.

Step 2: Push the ear dome rim membrane outward.

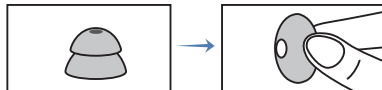

Step 3: Hold on to the end of the hearing amplifier and push firmly to ensure that the dome is fastened securely.



Notes:

After the ear dome is installed, pull the ear dome gently to see if it is firmly installed and ensure the ear dome does not fall off easily.

⚠ WARNING:

It may be in few circumstances that the ear dome remain attached to the auditory meatus after the hearing aid is taken out. In that case, please ask a professional doctor to take the ear dome out. Do NOT deal with it yourself, you could easily cause further damage.

【LEFT & RIGHT HEARING AMPLIFIER MARKINGS】

There is a R or L marking on the hearing amplifier. This will tell you if it is a left or a right hearing amplifier.

Blue marking for left hearing amplifier.

Red marking for right hearing amplifier.



Helpful Hints

- Minor irritation and/or inflammation may occur as your ear becomes accustomed to having an object in it; if so, please contact your hearing professional. There are several different sizes of ear domes that may be more comfortable.
- If an actual allergic reaction occurs, alternative ear dome materials are available; contact your hearing professional.
- Severe swelling, discharge from the ear, excessive wax or other unusual conditions warrant immediate consultation with a physician.

【VOLUME ADJUSTMENT】

The volume adjustment has two functions. It functions as an on/off control and a volume control. The volume wheel has numbers on it from 0(minimum) to 3(maximum).

On/Increase: Rotate volume wheel up

Off/Decrease: Rotate volume wheel down

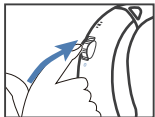

Turn On/Increase

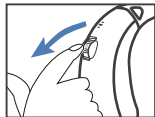

Turn Off/Decrease

Note:

1.The hearing amplifier built in with 'delay turn on' function. It will beep and then take a few seconds to begin amplifying sound when the hearing amplifier is turned on.

2.To avoid a sudden blast of sound, please raise the volume slowly.

【HEARING MODE CHANGE】

The hearing amplifier has 4 different hearing modes.

You can cycle through the 4 hearing modes by long press of the hearing mode button to change the hearing mode.

* The hearing amplifier is designed with the memory function:
The hearing amplifier can automatically record the previously tuned hearing mode.

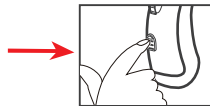

Hearing Mode	Sound you will hear when activated	Mode
1	1 beeps ("beep")	Quiet
2	2 beeps ("beep beep")	Social
3	3 beeps ("beep beep beep")	Noise Reduction
4	4 beeps ("beep beep beep beep")	Restaurant

【REPLACING TUBING】

- 1.Remove tubing: Rotate tubing base 90° counter-clockwise and slide off. You may experience resistance when removing the tubing for the first time.
- 2.Attach tubing: Gently push new tubing on.
- 3.Make sure tubing base in flush with sides of hearing amplifier body when you are finished.

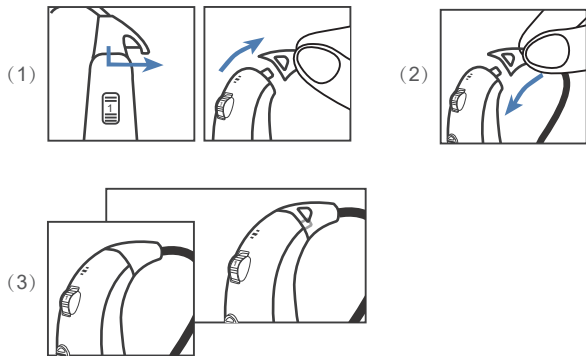

【HOW TO USE THE CHARGING CASE】

1. Make sure the hearing amplifier is turned off when charging. Plug the larger end of the charging cable into the power supply such as a power charger or your computer.
 2. Plug the smaller end into the Micro USB port on the hearing amplifier charger case.
 3. The charging case will charge via the USB port on the case. When the case is charging, the indicator shows a blue solid light, and fully charged the indicator light will show a solid green light will be constant .
- *The fully charging case offers 3 full charging cycles for a pair of hearing amplifiers.
4. The charging process will automatically stop when the case and hearing amplifiers are fully charged, so the hearing amplifiers can be safely left in the charger. Place it on a flat even surface away from exposure to moisture, dust, or extreme temperatures.

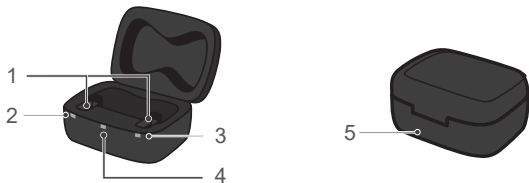

1. Charging slot of the hearing aid
2. Left-side hearing aid charging indicator
3. Right-side hearing aid charging indicator
4. Charging case charging indicator
5. Micro USB connection to external power supply

Light	Device	Meaning
Blue	Hearing amplifiers or case	Charging
Solid Green	Hearing amplifiers or case	Fully charged
Flashing Green	Case only	Less than 20% power
Off	Hearing amplifiers or case	Not charging

Note:

1. Charging case Low Power: The charging case indicator will flash green when the charging case battery drops below 20%, please charge the case.
2. When the hearing amplifier and case is not functioning properly, please check the “charging case troubleshooting table”. If none of the solutions work, please contact our after-sales service team.

All data in this manual, such as service time, charging time, continuous working time, and charging times are derived from our internal laboratory testing and meant for reference purposes only. Your exact usage and times may differ depending on various conditions and use patterns. It is a normal phenomenon to hear some high-pitched whistling or buzzing when the hearing amplifier is at a high volume level and not fitted well into the ear as a result of mic feedback. If this occurs, lower the volume and adjust the hearing amplifier within the ear. Also check to make sure you are wearing the best size ear domes to ensure a proper fit in the ear canal, as this may also induce some minor feedback if not snug in the ear.

V. MAINTENANCE AND CLEANING

1. Daily maintenance

It is important to keep your devices clean and dry. On a daily basis, wipe them clean using a soft cloth or tissue. To avoid potential damage from excess humidity or perspiration, the use of a drying kit is also recommended.

2. Care and maintenance

When not in use, store in a secure area away from small children and pets.

Do not place hearing amplifiers or charging case near high-temperature areas such as stoves or direct sunlight.

Do not leave the devices in a humid place for a long time, such as bathroom.

Take care not to poke the microphone holes with any sharp objects to avoid damage.

Do not disassemble or attempt any repairs by yourself. Doing so will void your warranty.

3. Cleaning

1) Cleaning the ear tips

Remove any earwax buildup using the enclosed tool. Wipe clean with a tissue or soft cloth.

2) Cleaning Tool

Use a soft cloth or tissue to wipe any moisture, perspiration, or debris from the surface of the tool.

Note: Do not use alcohol or other cleaning solvents to clean the hook as this could damage the protective covering.

VI. HEARING AMPLIFIERS CARE

- Keep your hearing amplifiers clean. Extreme temperatures (heat or cold), moisture, and foreign substances can result in poor performance.

- Use the cleaning brush tool or soft cloth to clean debris from around the buttons, microphones, and charging contacts; inspect the receiver, ear tips, and charging case regularly.

- Never use water, solvents, cleaning fluids or oils to clean your hearing amplifiers.

- Charging contacts should always be kept clean and dry.

- Always store your hearing amplifiers in the charging case when not in use or cleaning.

Charging Case Care

- Keep your charger clean. Heat, moisture and foreign materials can result in poor performance.

- Using the provided cleaning brush keep the charging ports clear of debris.

- Do not use water, solvents or cleaning fluids to clean the charging ports.

- Keep lid closed as much as possible to avoid dust and debris build up.
- Store your charger in a clean and dry location, i.e. a dresser or shelf rather than the bathroom or kitchen.
- To ensure the longest life of your rechargeable hearing amplifiers batteries and the batteries in the charger:
- Fully charge hearing amplifiers batteries every night.

Service and Repair

If, for any reason, your hearing aid does not operate properly, do NOT attempt to fix it yourself. Not only are you likely to violate any applicable warranties or insurance, you could easily cause further damage. Should your hearing amplifier fail or perform poorly, check the Troubleshooting Guide on the next page for possible solutions. If problems continue, contact us or your hearing professional for advice and assistance. Many common problems may be solved right in your hearing professional's office or clinic.

⚠ WARNING:
DO NOT OPEN HEARING AMPLIFIER OR CHARGER, NO USER-SERVICEABLE PARTS INSIDE.

VII.TROUBLESHOOTING GUIDE

SYMPTOM	POSSIBLE CAUSES	SOLUTIONS
No Sound	Battery fully discharged	Connect the hearing amplifier to the charging case for charging
	Volume too low	Increase volume if volume control available
	Device is not charged	Place charging the hearing amplifier until the indicator is lighted in green color
	Microphones are clogged	Clean out any debris from the mic holes
Hearing amplifier not loud enough, unclear or distorted	Ear domes or speaker tip are clogged	Clean out any debris from the ear domes and receiver area with the cleaning brush
	Low battery	Charge hearing amplifier
	Volume too low	Increase volume if volume control available
	Ear Domes are too loose	Hearing amplifier not inserted correctly into ear , wear it correctly

Hearing amplifier not loud enough, unclear or distorted	Earwax in ear dome	Clean out any debris from the ear domes and receiver area with the cleaning brush
	Hearing has changed	Contact your hearing care professional
Hearing amplifier too loud	Volume too loud	Decrease volume if volume control available
Hearing amplifier whistles	Hearing amplifier not inserted correctly into ear	Insert hearing amplifier correctly
	Ear domes are too loose	Hearing amplifier not inserted correctly into ear, wear it correctly
	Hearing amplifier not inserted correctly into charger	Insert hearing amplifier correctly into charger

hearing amplifier failure self-checking table

[Fault self-check] project	Possible Causes	SOLUTIONS
Indicator light of hearing amplifier does not light up when hearing amplifier placed in charging inserts	Poor contact between hearing amplifier and charging case	Reinsert the hearing amplifier into the charging case
	Hearing amplifier not inserted correctly into charger	Insert hearing amplifier correctly into charger
	Charger not connected to power source	Connect charger to external power supply
	Battery fully discharged	Wait five hours after placing hearing amplifier in charger, regardless of LED behavior
Hearing amplifier indicator lights are dark or dim	Battery fully discharged	Connect USB cable to charge
	Dirty charging contacts	Clean the contacts of the hearing amplifier and the charger
Charging does not start	Hearing amplifier not inserted correctly into charger	Insert hearing amplifier correctly into charger

Hearing amplifiers whistling in the charger	Charger battery depleted	Ensure the USB cable is connected to the Charging case plugged into power. The Case power status lights will show a solid blue to indicate charging.
	Incorrect orientation	Reposition your hearing amplifiers in their slots, ensuring the contact points are touching the charge points in the case.

Charging case fault self-checking table

*Note: If the problem persists, contact your hearing care professional for assistance.

VIII. TIPS FOR BETTER COMMUNICATION

It will take practice, time, and patience for your brain to adapt to the new sounds that your hearing amplifiers provide. Hearing is only part of how we share thoughts, ideas and feelings. Reading lips, facial expressions, and gestures can help the learning process and add to what amplification alone may miss.

Please review the following simple communication tips:

For You

- Move closer to and look at the speaker
- Sit face-to-face in a quiet room if possible
- Try out different locations to find the optimal places to listen
 - Minimize distractions
 - Background noises may be frustrating at first; remember, you have not heard them for a while
 - Let others know what you need; keep in mind that people cannot “see” your hearing loss
 - Develop realistic expectations of what your hearing amplifiers can and cannot do

- Better hearing with hearing amplifiers is a learned skill combining desire, practice, and patience. You will learn and adjust, it just takes a little time. Remember to be patient with yourself.

For Your Family and Friends

Your family and friends are also affected by your hearing loss.

Request that they:

- Get your full attention before beginning to speak
- Look at you or sit face-to-face
- Speak clearly and at a normal rate and level; shouting can actually make understanding more difficult
- Rephrase rather than repeat the same words; different words may be easier to understand
- Minimize distractions while speaking

IX. TECHNICAL SPECIFICATION

Output. OSPL ₉₀ Max.	≤125dB+3dB
High frequency average OSPL ₉₀	114dB±4dB
EQ Input Noise	≤29dB+3dB
Total Harmonic Distortion	≤7%+3%
Frequency Range(Not narrower than)	400Hz-4000Hz
Working Current	10mA
Operating temperature/humidity	-10℃~+40℃(14°F-104°F), ≥30%RH,≤75%RH
Storage temperature/humidity	-10℃~+55℃(14°F-131°F), ≥10%RH,≤90%RH







Item	Charging Case
Charging case Input voltage	d.c.5.0V
Charging case Input current	1A
Charging case Output current	≤40mA
Charging case Output voltage	d.c.4.2V

X. Accessories List

Charging Case; 1
Hearing Amplifier: 2
Ear Dome: 6
Cleansing Tools: 1 Manual: 1
USB Cable: 1

* Optional accessories list:
Adapte: 1
Input: 100-240V~50/60Hz 0.2A
Output: 5V  1A 5W

XI. NORMALIZED SYMBOLS

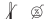
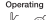
	Follow operating instructions
	B type applied part
	Disposal in accordance with Directive 2002/96/EC (WEEE)
	CE Labeling This product satisfies the requirements of the applicable European and national directives
	Date of manufacture
	Serial number
	Warning/ Danger: Improper use might cause serious injuries.
IPX5	Test Condition: Water flow rate: (12.5+/-5%) L/min Test time: at least 3 min After the test, the PCB board of the product is allowed to into water, but the product function is normal.
Storage/Transport 	Permissible storage and transport temperature and humidity
Operating 	Permissible operating temperature and humidity

XII. MAINTENANCE, STORAGE, AND DISPOSAL

Maintenance

- 1) We do not authorize any institution or individual to maintain and/or repair the product. If you suspect that the products may be in question, please contact us immediately.
- 2) The user must not attempt any repairs to the device or any of its accessories. Please contact us for any repair needs.
- 3) Opening of the equipment by unauthorized agencies is not allowed and will terminate any claim to warranty. Warning: No modification of this equipment is permitted.

Storage

- 1) Always store your devices in the Charging Case when not in use.
- 2) Do not store or expose the devices and/or case to extreme hot/cold temperatures, moist/humid environments, or shock/vibration.
- 3) Keep the devices and case in following environmental ranges: $-10^{\circ}\text{C} \sim 55^{\circ}\text{C}$, 10%-90%RH, 700-1060 hPa

Disposal



Please dispose of the device in accordance with the directive 2002/96/EC – WEEE (Waste Electrical and Electronic Equipment). If you have any questions, please refer to your local authority responsible for waste disposal.

XIII.WARRANTY

This limited warranty covers defects in material and workmanship for a period of two (2) years from the date of purchase, which includes the hearing devices, charger case, and cord within the warranty period.

Any damage caused by improper handling and care, exposure to elements or chemicals, or unauthorized service will not be covered by the warranty. All other damage claims excluded. A warranty claim must be submitted with the purchase receipt.



Huizhou Jinghao Medical Technology Co., Ltd.

Address: Floor 6, Huicheng Industry Building, No.9 Huifeng Dong'er Road, Zhongkai High-tech Zone, Huizhou City, Guangdong Province, China.

Tel: +86-752-2266961

Email: emily@jhhearingaids.com